

RadioControl/AMVR On-Road Challenge 2014

The RadioControl/AMVR On-Road Challenge will be held on AMVR racing track located in the north of Portugal, Vila Real, where the 1/8th European Championships took place in 2012.

The tradition of motor sports in Vila Real, goes back to 1931. The citadine circuit is the premium event but the local club also organizes rally, european autocross and ralicross, mountain course and karting.

We expect fair behavior and sportsmanship from all the drivers. Entries don't have limit, but the race timetable may be modified by us depending the number of drivers entries. We'll inform you about any change in the timetable.

Our RC Trophy will have three race events on the following dates :

- 12/13 April
- 6/7 September
- 25/26 October

Each race will be open for 1/8th and 1/10th 200mm nitro on-road cars and all racing events will counting to the final score.

Final prizes in the end of trophy for both classes (1/10th | 1/8th):

- 1st place - Engine
- 2nd place - Exhaust kit complete
- 3rd place - Can of Maxima Fuel + Set Hot Race tires

The Trophy rules will follow the EFRA regulation and FEPRA rules as fair as possible for all the drivers.

Timetable

- **April 12** (Saturday) the track is open for free practice, technical inspections
- **April 13** (Sunday) 8:00 AM track is open;
- 8:30 Transmitter depot
- 8:45 Briefing
- 9:00 Start of the qualify rounds with 3 rounds of qualification
- 12:30 – 13,30 Lunch time
- 13:30 Start of the sub-finals
- 16:30 main final 1/10 (30m)
- 17:30 main final 1/8 (45m)
- 18:30 prizes ceremony
- 19:30 end of event

Race Procedure

Free Practice

If the number of drivers will not exceed 15 in both classes (1/10th & 1/8th) we will have free practise without timing.

Timed Practice

If the number of drivers entry will exceed 15 in both classes we will make during Saturday 3 rounds of free practice with five minutes plus three minutes for warm-up ,counting the average of the best three consecutive laps.

Qualification

3 rounds of qualification for every driver, the rounds will be five minutes. The best two round out of three will determine the qualification standing.

Finals

- The finals will be raced according to the christmas tree style.
- The duration of the finals will be 45 minutes for 1/8th and 30 minutes for 1/10th
- For sub-finals the duration it will be 20 minutes.
- The drivers with the ranked 1,2,3,4 in the sub-final will move up to the next round of finals.

The drivers from the main final can request 10 minutes delay but only before the drivers have been called to the starting grid.

Tires

- All drivers will receive 1 set of Hot Race Tires in the entry and after pay and confirm the race registration
- Exclusive trophy price for Hot Race Tires:
 - 20€ Set for 1/8 with 32 (front) and 35 (rear) in black rims
 - 13,50 Set for 1/10th with 37 (front) and 40 (rear) in black rims



Attention: Any treatment of the tires with additives/substances is prohibited.

Fuel

Maxima Tarmac 16% will be available for you if you make a pre request on the pre-registration form at least two weeks before the race weekend:

Maxima fuel will have the following price for this trophy: Can of 4,5L (16% Nitro) = 28,60€

Technical rules 1/8:

Overall dimensions:

Width: Max. 267 mm Height: Max. 170 mm / 180 incl. gurney on 20 mm blocks.

Weight: Min. 2400 g incl. transponder with empty fuel tank. Fuel tank: Max. 125 ml incl. fuel tube.

Body: All current LMP 1/8th scale bodies EFRA approved. Engine: Max. 3,5 ccm.

Exhaust: EFRA approved Carburetor: Max. 9.0 mm intake diameter. INS-box: Regular EFRA approved

INS-Box is mandatory. Fuel: May only contain methanol, lubricating oil and nitro methane (16%).

Technical rules 1/10:

Overall dimensions:

Width: Max. 200 mm (without body). Height: Min. 120 mm on 10mm blocks.

Weight: Min. 1650 g incl. transponder and with empty fuel tank. Fuel tank: Max. 75 ml incl. fuel tube.

Body: Regular 200 mm touring car bodies.

Cut-outs:

Rear of the body no higher than 50 mm on 10 mm blocks. Cooling / refueling-hole: max. 60 mm; front side window and rear window can be cut out.

Wing: Max. depth 55 mm; not higher than the roof. Side dams: Max. 55 mm x 35 mm. Engine: Max. 2,11 ccm / 3-ports.

Exhaust: EFRA approved. Carburetor: Max. 5.5 mm intake diameter. INS-box: Regular EFRA approved INS-box is mandatory. Fuel: May only contain methanol, lubricating oil and nitro methane (16%).

Track:

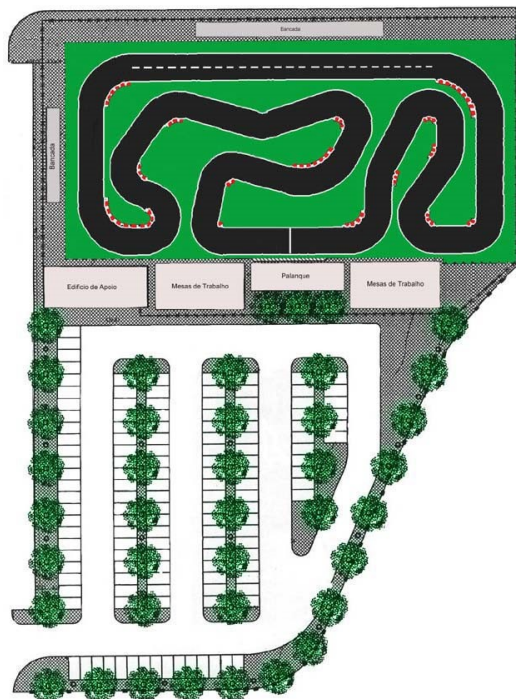

Characteristics of the velocity circuit								
Length	Average width	Asphalt	Interior of Circuit	Covered podium		Boxes for 200 pilots*		
				Length	Height	Length	Width	Height
420m	5.5m	Rough and draining	Synthetic grass	17.3m	3.5m	3m	1.6m	1m
				Working boxes with two sectors, with a total of 24 working places				
The complex is equipped with:								
<ul style="list-style-type: none"> • Boxes for more than 200 pilots <ul style="list-style-type: none"> • Compressed air • Light and electricity at 220v. • Covered Benches for 1000 persons • Support building where is located the headquarters, room for Slot cars, bar, room for AMB system and WC. • Parking for more than 500 cars 								

AMVR Track Address:

Complexo Desportivo Monte da Forca

5471 Vila Real, Portugal

AMVR GPS coordinates 41.287949,-7.754438

Accommodation:



Hotel Miracorgo ***Avenida 1º de Maio, 76/785000-651 Vila RealT. 259 325 001 / F. 259 325 006Web page: www.hotelmiracorgo.com E-mail: info@hotelmiracorgo.com Coordonnées GPS: 41°17'43.47"N 7°44'38.51"O



Hotel Miraneve **Rua D. Pedro de Castro5000-669 Vila RealT. 259 323 153 / F. 259 323 028Web page: www.hotelmiraneve.com E-mail: hotelmiraneve@live.com.pt Coordonnées GPS: 41°17'56.96"N 7°44'48.44"O



Estalagem Quinta do Paço ****Estrada Nacional 322, Arroios,5000-051 Vila RealT. 259 340 790 / F. 259 340 799Web page: www.quintapaco.com E-mail: hotel@quintapaco.com GPS: 41°17'33.55"N 7°42'26.17"O



Residencial "Encontro"Av. Carvalho Araújo, nº 76/78,5000-657 Vila RealT. 259 322 532E-mail: residencialencontro@sapo.pt GPS: 41°17'47.28"N 7°44'45.30"O

NO IMAGE

Residencial "Clássico"Urbanização de S. Lourenço,Lote 3C – Lordelo, 5000 Vila RealT./F. 259 341 795Web page: www.residencialclassico.com E-mail: residencialclassico@hotmail.com GPS: 41°18'24.54"N 7°45'27.16"O



Residencial "Real" Rua dos Combatentes da Grande Guerra, nº 5, 5000-635 Vila Real T. 259 325 897 / F. 259 324 613 Web page: www.residencialreal.com / E-mail: hotelreal@sapo.pt
GPS: 41°17'48.21"N 7°44'42.01"O

NO IMAGE

Residencial Aquarius Rua Nova das Botelhas 5000-512 Vila Real T. +351 259 323 787

NO IMAGE

Carreira,

Camping à Vila Real Rua Dr. Manuel Cardona, Quinta da

5000-558 Vila Real

T. 259 324 724

GPS: 41°18'12.94"N 7°44'13.23"O

Entry fee 1/8th: 25 euros/driver

Entry fee 1/10th: 25 euros/driver

Plus 15€ just in the first race for each class for issue the driver license with sports insurance included.

All drivers interested to attend to our trophy events will have to send a confirmation of their attendance with a minimum of 15 days before the race day. Respecting this time we can guarantee a set of tires for each driver and fuel option for who request it.

Race registration:

MYRCM web page:

[http://www.myrcm.ch/myrcm/main?pLa=pt&tId=E&hId\[1\]=org&dId\[O\]=3609&pId\[O\]=10](http://www.myrcm.ch/myrcm/main?pLa=pt&tId=E&hId[1]=org&dId[O]=3609&pId[O]=10)

RadioControl web page: <http://www.radiocontrol.pt/content/12-pre-registration-form>

AMVR web page: <http://www.amvr.pt/trofeu-radiocontrolamvr/>

Pre-registration is open now, feel the race!

Pre-Registration Form

Track: AMVR (VILA REAL);

Date: ___/___/___

Name: _____; Surname: _____

Driver Licence: _____

Transponder nº.: _____

Scale: 1/10 ___ 1/8 ___

Brand/Chassis model: _____

Brand/Engine model: _____

Extra Tires (SET) quantity : 1 SET___ 2 SET___ ()SET

Tires Trophy Price (SET): 13,50€ for 1/10 ; 20€ for 1/8

Fuel Option (Maxima Tarmac 16% Nitro 4,5L) 28,60€ :

Yes ___ No___ Quantity___

Attention: maximum cans allowed per race = 2 Cans of 4,5L

1^a. Frequency: _____ 2^a. Frequency: _____

3^a. Frequency: _____ D.S.M. _____

Please copy the Pre-Registration Form to a Word file and send it completed and signed up until Friday, one week before the race weekend. It must be submitted to RadioControl through the email: team@radiocontrol.pt or to AMVR RC Club through the email: amvilareal@gmail.com

Respecting the timing for pre-registration will allow us to provide you a Set(s) of tires and fuel as you requested.

For further questions about registration or race rules don't hesitate to contact us.

Visit us on facebook:

www.facebook.com/RadioControl | www.facebook.com/associacao.modelismovilareal